

Wall mounting template for the Cliptel 50

Please read the instructions in the User Guide before you start to wall mount your Cliptel 50.

If you prefer, you can stand your Cliptel 50 on a level surface.

Fit a battery, as described in the User Guide, before you wall mount the Cliptel 50.

- 1 If necessary, change the position of the hook on the base so that it will hold the handset in position.

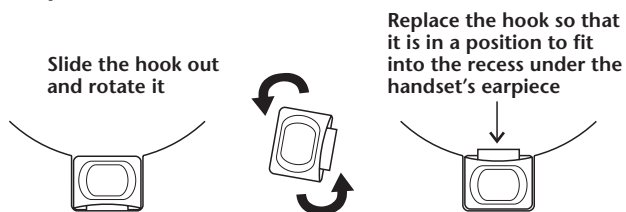

- 2 Tuck the telephone line cord into the groove on the underside of the telephone base

BE CAREFUL — check that there are no electrical wires hidden in the wall.

- 3 Mark the wall at the two fixing centres. The marks should be 82 mm apart.
- 4 Drill holes in the wall at the points you have marked.
- 5 Fit wall plugs if necessary, and the two screws supplied. Leave about 5–7 mm between the wall and the underside of the screw heads.
- 6 Hang the telephone base on the screws so it fits securely and does not wobble. You may need to remove it and tighten the screws slightly.
- 7 Make sure the handset rests securely on hook.

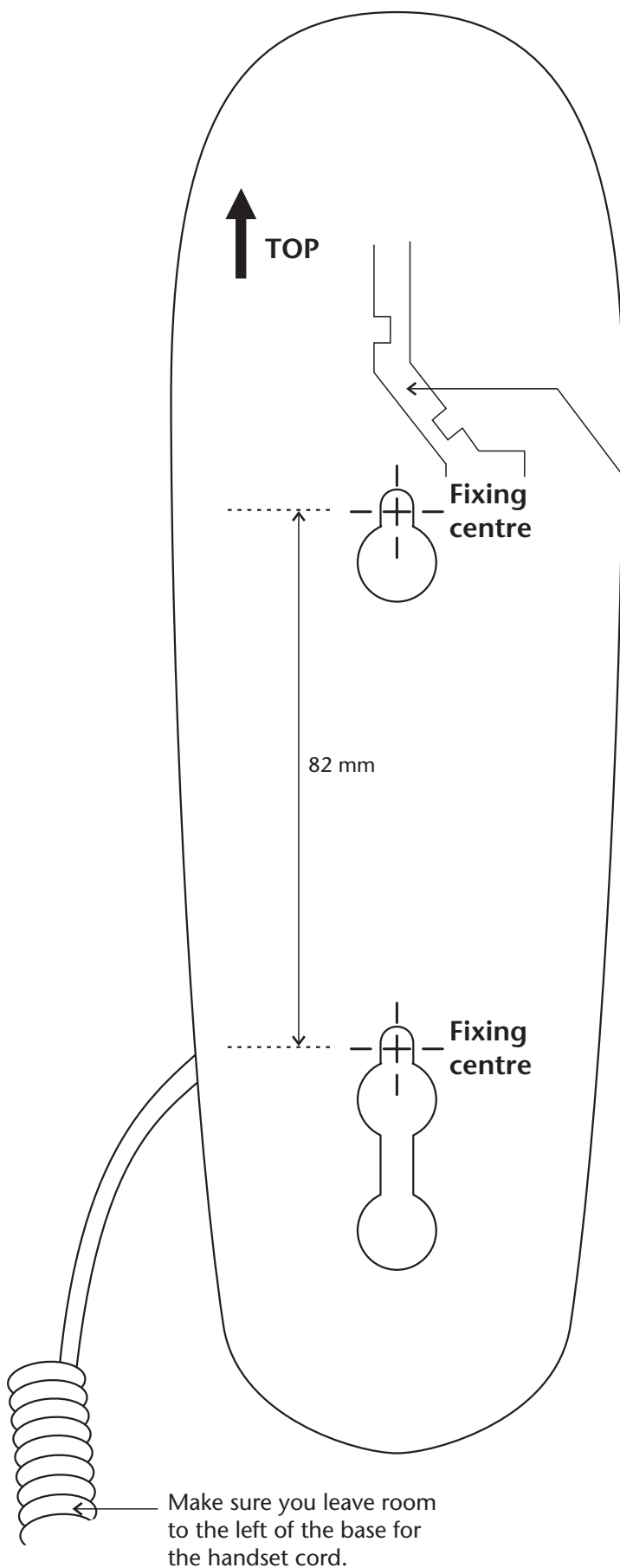

DECLARATION OF CONFORMITY

We: Binatone Telecom Plc OF: Unit 1, Ponders End Industrial Estate
East Duck Lees Lane
Enfield, Middlesex
EN3 7SP, United Kingdom

Declare under our sole responsibility that the product:

CLIPTEL 50

To which this declaration relates, complies with all the essential requirements of the EMC Directive 89/336/EEC and Low Voltage Directive: 73/23/EEC

Signed: _____

Date: 28th October 1999

John Porter — Operations Director

